

**best quality!  
best price!  
best location!**



**FLATS FOR SALE**  
@ Anjanadri Nagar,  
HAYATHNAGAR



**G+4 - 8 Flats**

**EAST Facing Flats 1216 Sft.**

**NORTH Facing Flats 1120 Sft.**

- 10 Min. Drive from Nagole Metro Station
- Kamineni Hospitals - 2 km
- Sunrise Hospitals - 2 km
- Hotels - 2 Km
- Bank - 1.5 Km
- Police Station - 2 Km
- School - 1Km
- Shopping Mall - 4 Km
- Park
- Petrol Bunk - 2 Km

**AMENITIES**

- ▶ 2 BHK Flats
- ▶ Loan Facility Available
- ▶ Lift Facility Available
- ▶ Generator backup
- ▶ Car Parking Available.
- ▶ Bus Facility Available
- ▶ 100% Vaastu

**Only 2 Kms. from National Highway**

**FLOOR PLAN**

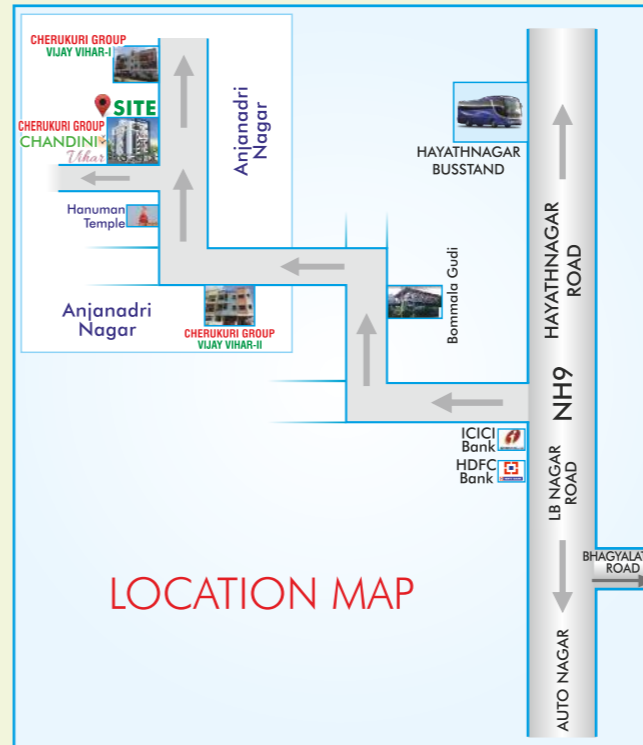
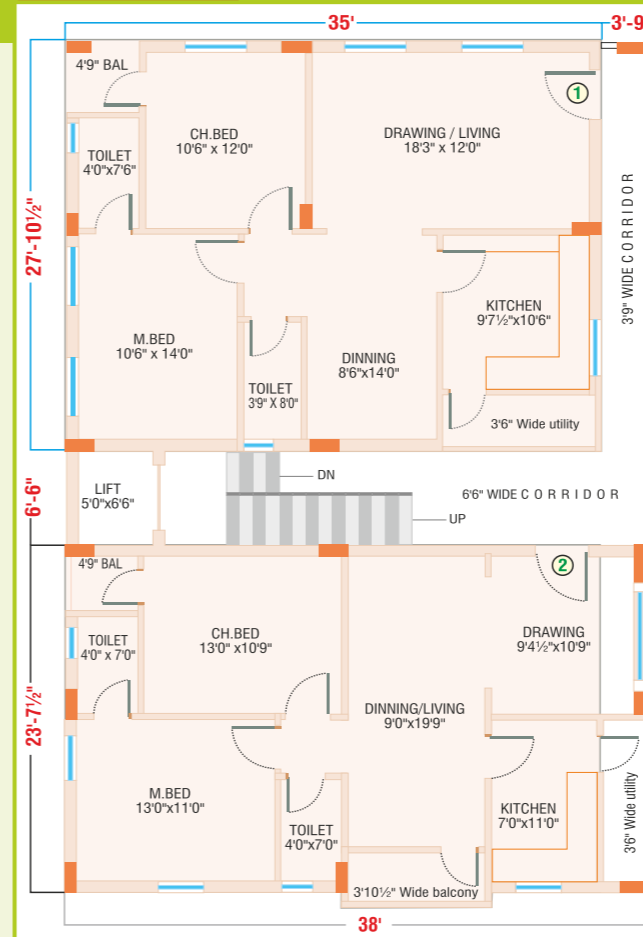

<b>STRUCTURE</b>	Framed Structure : R.C.C. framed structure to withstand Wind & Seismic Loads. Super Structure : 9" thick solid block work for external walls & 4" thick solid block work for internal walls.
	Plastering : Internal: 2 coats of plastering in CM 1:6 for walls and Ceiling. External: 2 coats of plastering in CM 1:6 for External walls.
<b>DOORS</b>	Main Door : Best Teak Wood frame with Teak wood shutter polishing and premium quality fixtures and fittings. Internal Doors : Solid Moulded flush doors with lappam paint finishing.
<b>WINDOWS</b>	UPVC windows of leading brand.
<b>GRILLS</b>	Aesthetically designed, Mild Steel (M.S) grills with Enamel paint finish.
<b>PAINTINGS</b>	External Painting : 2 coats of Apex Ultima Exterior Emulsion Paint (Asian Paints) after make over 1 coat of Primer. Internal Painting : Smooth lappam finish with Royal Emulsion Paint (Asian Paints) after make over 1 coat of Primer.
<b>FLOORING</b>	Living, Dining, Bedroom & Kitchen : Swastik Brand Premium Quality Vitrified Tiles. Size (24"x24"). Bathrooms : Swastik Brand tiles which are Acid Resistant, Anti-skid Ceramic Tiles 8"x12" Glazed ceramic Tile dado up to 7'-0" height. Tiles Cladding : Dadoing In Kitchen : Swastik Brand glazed Tiles dado up to 2'-0" height above kitchen platform. Kitchen Platform : 1. Polished black Granite Platform with Stainless Steel Sink . 2. Provision of treated water (Manjeera or any other water provided by GHMC along with Borewell water).
<b>UTILITIES/WASH</b>	Provision for Washing Machine & Wet Area for Washing Utensils etc.
<b>BATHROOMS</b>	1. Western Commode wash basin. 2. EWC with Flush Tank of Reputed Make. 3. Hot & Cold wall Mixer with Shower. 4. Provision for Geysers in all Bathrooms. 5. Premium quality Sanitary fixtures.
<b>ELECTRICAL</b>	1. Fire-resistant low smoke cabling with modular switches of make Anchor ROMA / MARU or equivalent 2. Concealed Copper Wiring of reputed make. 3. Power outlets for Air Conditioners in all bedrooms. 4. Power outlets for geysers in all bathrooms. 5. Power plug for cooking range chimney, refrigerator, microwave ovens, mixer / grinders in kitchen. 6. Single phase supply for each unit and individual Metre Boards. 7. Miniature Circuit breakers (MCB) for each distribution boards of reputed make
<b>CABLE TV</b>	Provision for Cable Plug Connection in Living Room.

